



The Olivia

3 Beds | 2 Baths | 1,516 Sq Ft*



FARMHOUSE



COTTAGE



SAY HELLO TO EASY LIVING. Open, airy, and thoughtfully designed on one level, The Olivia makes everyday life feel beautifully uncomplicated. Get lost preparing your favorite recipe in the kitchen, curl up with a good book in the great room, then retreat to the serenity of your private primary suite. From quiet mornings to restful evenings, The Olivia is designed to bring comfort, balance, and relaxation home.

*Exterior design, square footage and product selections may vary by elevation and neighborhood. Image is an artistic rendering of the home; colors and features may vary.

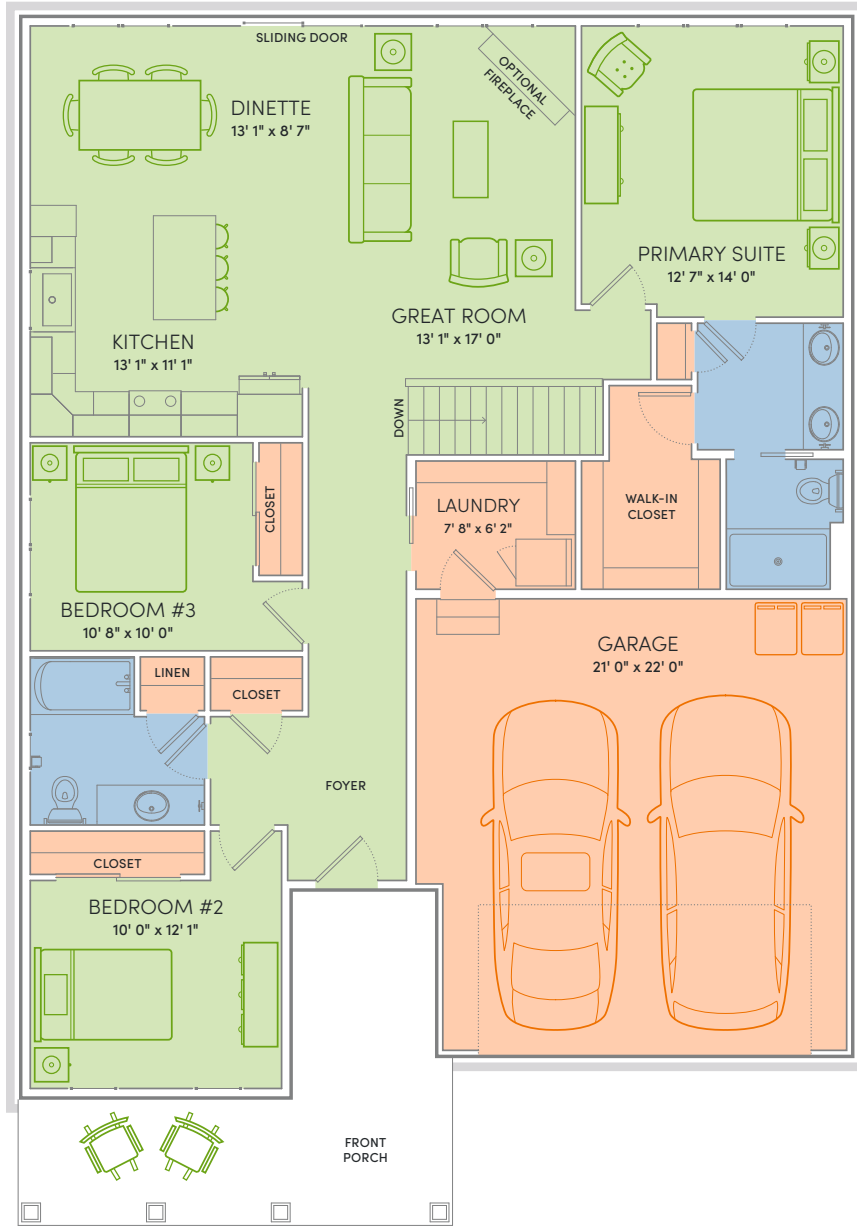

Floor Plan Features



- Locally made, custom Auburn Ridge® cabinetry, doors, and trim
- Quality finishes from trusted brands like Kohler®, Moen®, and Shaw®
- Stylish kitchen with island and quartz countertops
- Durable luxury vinyl plank flooring in main living areas
- Designer lighting collections curated from Kichler® and Visual Comfort & Co.
- Painted solid-core doors
- Smart Home+ technology with integrated lighting control
- One-year warranty for peace of mind
- Personalize your home with thousands of Design Studio options



ENERGY EXPERT CERTIFIED
Third-party tested to certify each home meets the high standards of the Quality 360® program.