



# The Margot

3-CAR FRONT  
LOAD GARAGE

4 Beds | 2½ Baths | 2,404 Sq Ft\*



COTTAGE



CRAFTSMAN



FARMHOUSE

**ALL WORK AND NO PLAY? NOT IN THE MARGOT.** This two-story home combines all the essentials you need with all the amenities you want. The laundry room has everything you'll ever need to keep things orderly. And when it comes to entertaining, the spacious kitchen and great room will have you and your guests covered. When the day winds down, you can rest easy in your new primary suite. Welcome to The Margot.

\*Exterior design, square footage and product selections may vary by elevation and neighborhood. Image is an artistic rendering of the home; colors and features may vary.

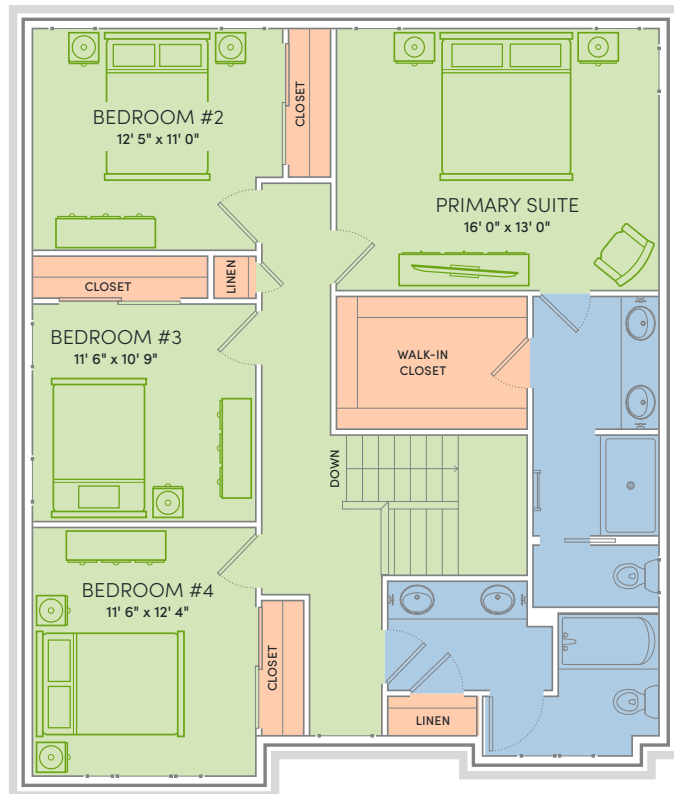
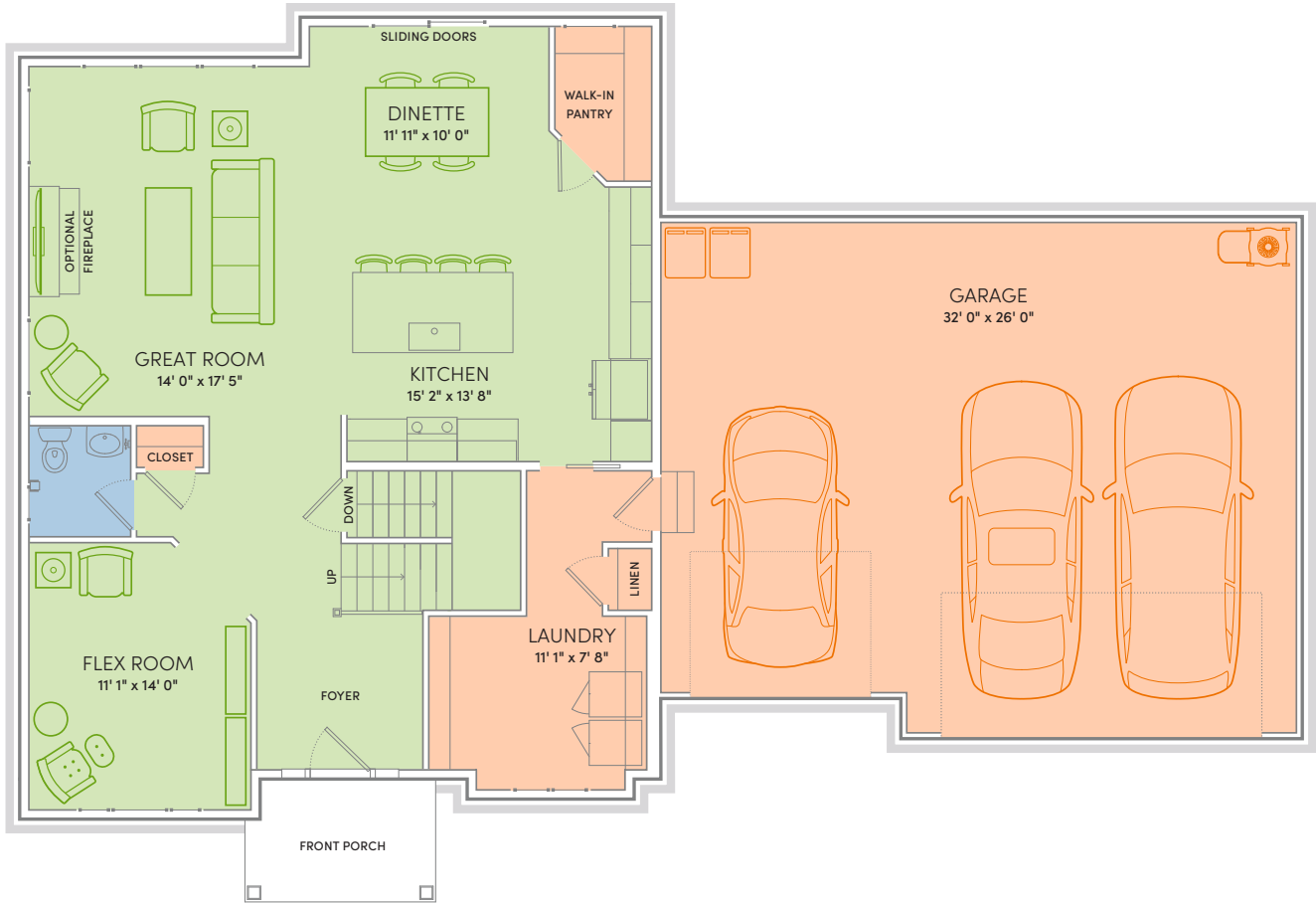

## Floor Plan Features



- Locally made, custom Auburn Ridge® cabinetry, doors, and trim crafted to last
- Quality finishes from trusted brands like Kohler®, Moen®, and Shaw®
- Stylish kitchen with island and quartz countertops
- Durable luxury vinyl plank flooring in main living areas
- Designer lighting collections curated from Kichler® and Visual Comfort & Co.
- Painted solid-core doors for sound control
- Smart Home+ technology with integrated lighting control and built-in USB connectivity
- One-year warranty for added peace of mind
- Personalize your home with thousands of Design Studio options



ENERGY EXPERT CERTIFIED  
Third-party tested to certify each home meets the high standards of the Quality 360® program.