



# The Kennedy

3 Beds | 2½ Baths | 1,844 Sq Ft\*



CALIFORNIA  
BUNGALOW



CRAFTSMAN



FARMHOUSE



PRAIRIE

**YOUR FIRST APARTMENT HAD... CHARACTER.** This primary suite has... everything your first apartment didn't. First on the list is space. Second is an enormous walk-in closet. Third is your very own bathroom with a dual bowl vanity and linen closet. Fourth is lots of light (it's a corner bedroom with lots of windows). And we haven't even told you about the rest of the house. Let's just say that your first apartment was your first for a reason.

\*Exterior design, square footage and product selections may vary by elevation and neighborhood. Image is an artistic rendering of the home; colors and features may vary.

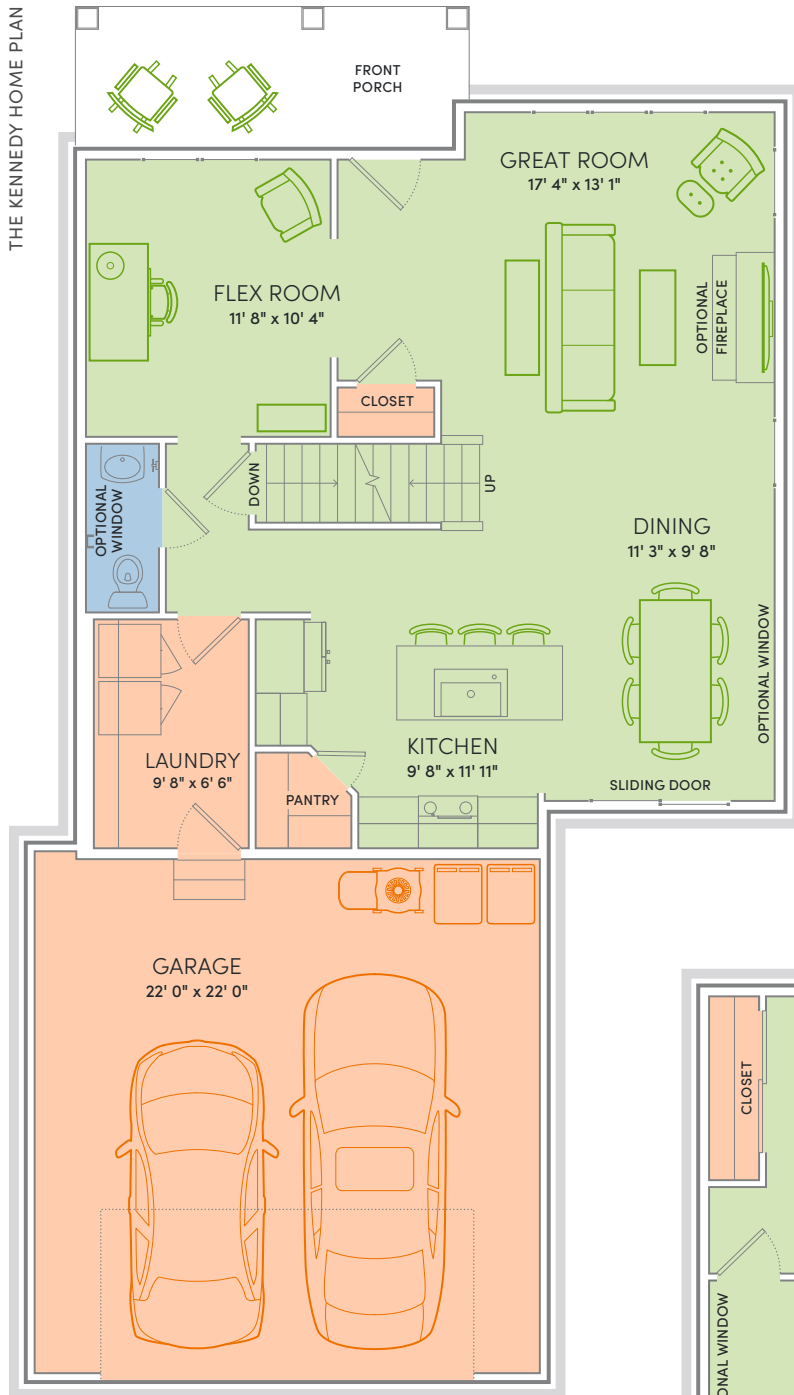

## ENERGY EXPERT CERTIFIED

Every Veridian home is tested by a third-party to certify it meets the high standards of the Quality 360® program.

## Floor Plan Features



- Locally made, custom Auburn Ridge® cabinetry, doors, and trim crafted to last
- Quality finishes from trusted brands like Kohler®, Moen®, and Shaw®
- Stylish kitchen with island and quartz countertops
- Durable luxury vinyl plank flooring in main living areas
- Designer lighting collections curated from Kichler® and Visual Comfort & Co.
- Painted solid-core doors for superior sound control
- Smart Home+ technology with integrated lighting control and built-in USB connectivity
- One-year warranty for added peace of mind
- Personalize your home with thousands of Design Studio options

