



# The Gramercy

3 Beds | 2½ Baths | 1,615 Sq Ft\*



**YOUR TAKEOUT NEVER TASTED SO GOOD.** No, it wasn't that the food was any different, it was where it was eaten. That's right, you ate at the best location around, at your brand-new kitchen island. The experience that The Gramercy has to offer you is like it was made just for you (because it was!). With an open and airy first floor and three private retreats upstairs, you are exactly where you should be. Welcome home to The Gramercy.

\*Exterior design, square footage and product selections may vary by elevation and neighborhood. Image is an artistic rendering of the home; colors and features may vary.

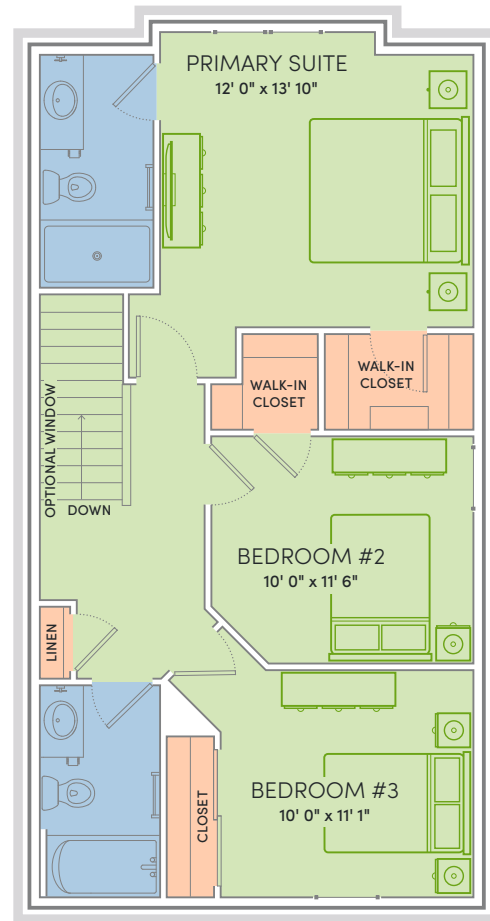
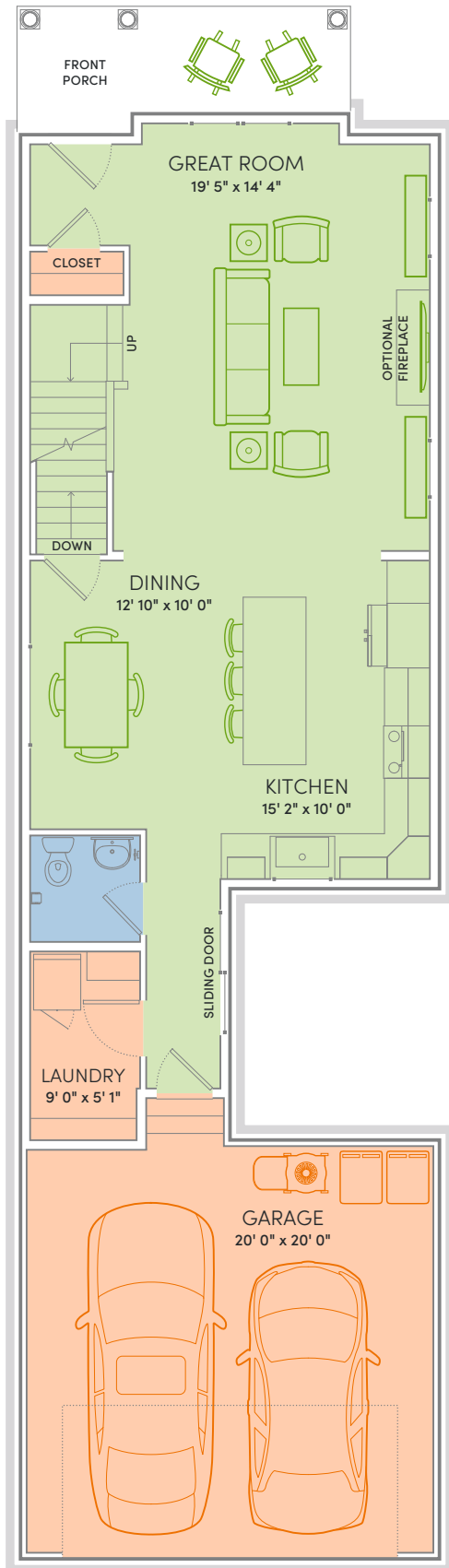

## Floor Plan Features



- Locally made, custom Auburn Ridge<sup>®</sup> cabinetry, doors, and trim crafted to last
- Quality finishes from trusted brands like Kohler<sup>®</sup>, Moen<sup>®</sup>, and Shaw<sup>®</sup>
- Stylish kitchen with island and quartz countertops
- Durable luxury vinyl plank flooring in main living areas
- Designer lighting collections curated from Kichler<sup>®</sup> and Visual Comfort & Co.
- Painted solid-core doors for superior sound control
- Smart Home+ technology with integrated lighting control
- One-year warranty for added peace of mind
- Personalize your home in our Design Studio



### ENERGY EXPERT CERTIFIED

Every Veridian home is tested by a third-party to certify it meets the high standards of the Quality 360<sup>®</sup> program.