



The Elaine

3 Beds | 2 Baths | 1,482 Sq Ft*



THE ELAINE WAS MEANT FOR EASY LIVING. Why wouldn't you have all of your desired amenities on a single floor, if you could do so? As you wake up from your primary suite and enter the main living space, flip on the television in the great room, start a pot of coffee in the kitchen and then check on your laundry, all in one quick pass. Take pleasure in the carefree lifestyle offered by the smartly designed Elaine.

*Exterior design, square footage and product selections may vary by elevation and neighborhood. Image is an artistic rendering of the home; colors and features may vary.

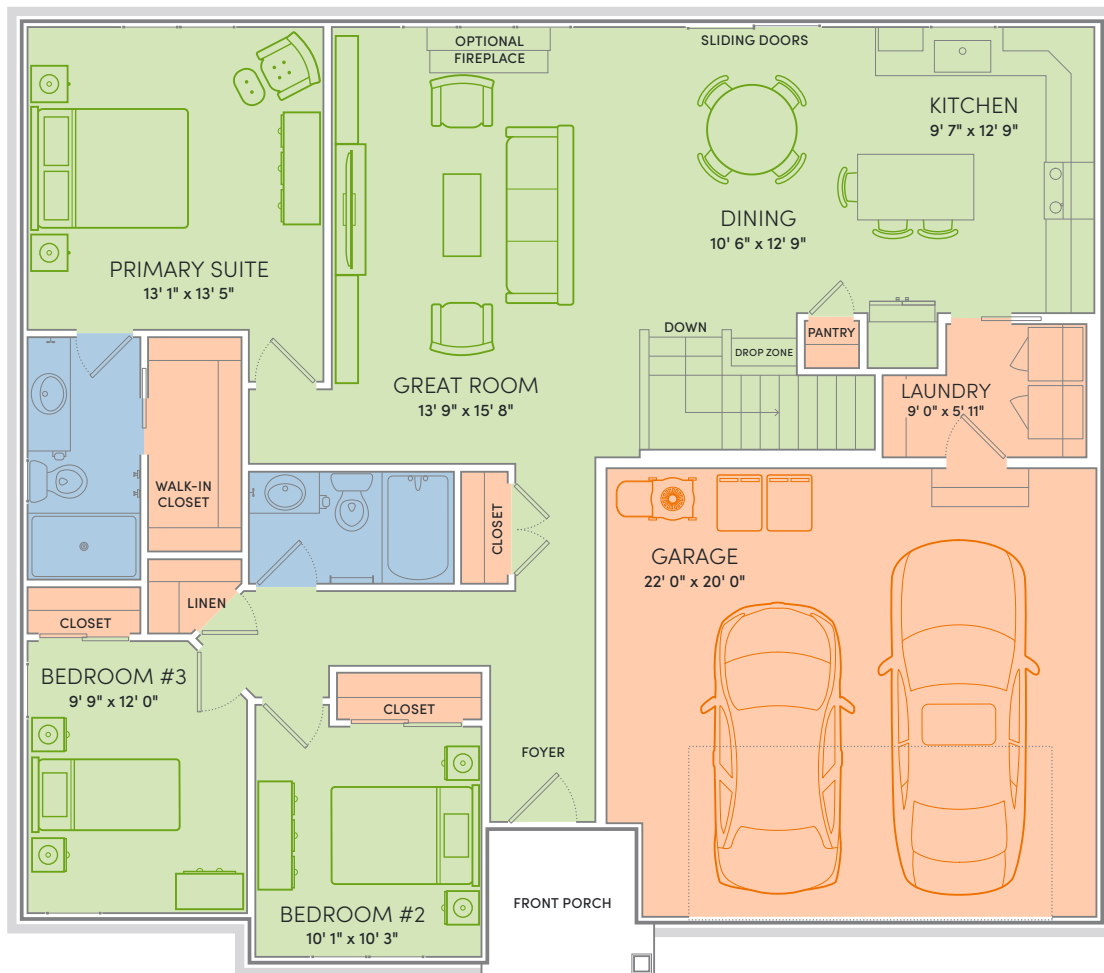

Floor Plan Features



- Locally made, custom Auburn Ridge® cabinetry, doors, and trim crafted to last
- Quality finishes from trusted brands like Kohler®, Moen®, and Shaw®
- Stylish kitchen with island and quartz countertops
- Durable luxury vinyl plank flooring in main living areas
- Designer lighting collections curated from Kichler® and Visual Comfort & Co.
- Painted solid-core doors for superior sound control
- Smart Home+ technology with integrated lighting
- One-year warranty for added peace of mind
- Personalize your home in our Design Studio



ENERGY EXPERT CERTIFIED

Every Veridian home is tested by a third-party to certify it meets the high standards of the Quality 360® program.