



The Caroline

3 Beds | 2 Baths | 1,503 Sq Ft*



COTTAGE



CRAFTSMAN



FARMHOUSE



NORDIC

MEET THE CAROLINE, A WARM, WELCOMING HOME where charming curb appeal meets everyday comfort. At the heart of the home, the kitchen offers ample prep space for your next Instagram-worthy dinner creation — whether you're meal-prepping for the week or hosting a meal for friends. From cozy evenings in to special get-togethers, this is a space designed to fit the way you live. Welcome home to The Caroline.

*Exterior design, square footage and product selections may vary by elevation and neighborhood. Image is an artistic rendering of the home; colors and features may vary.

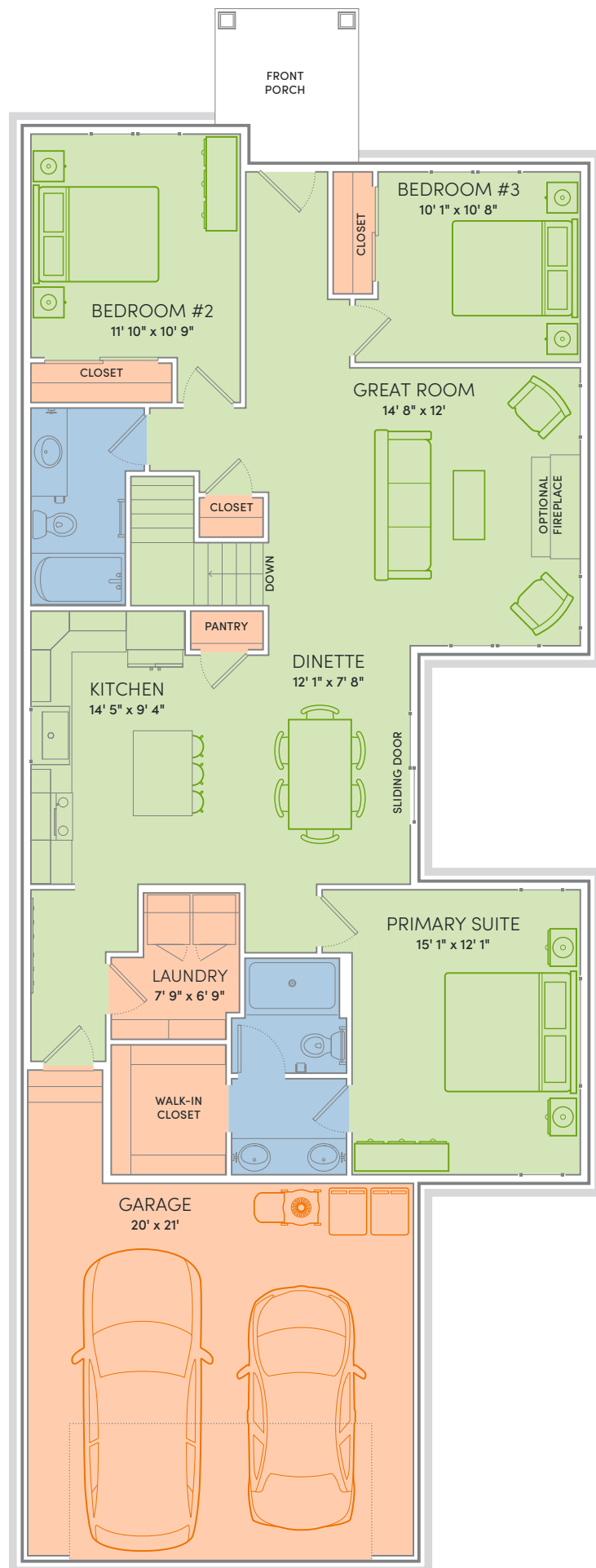

THE CAROLINE HOME PLAN

Floor Plan Features



- Locally made, custom Auburn Ridge® cabinetry, doors, and trim crafted to last
- Quality finishes from trusted brands like Kohler®, Moen®, and Shaw®
- Stylish kitchen with island and quartz countertops
- Durable luxury vinyl plank flooring in main living areas
- Designer lighting collections curated from Kichler® and Visual Comfort & Co.
- Painted solid-core doors for sound control
- Smart Home+ technology with integrated lighting control and built-in USB connectivity
- One-year warranty for peace of mind
- Personalize your home with thousands of Design Studio options

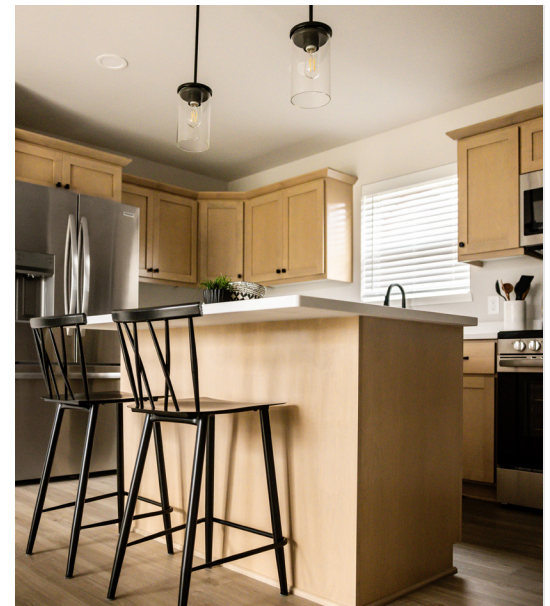

ENERGY EXPERT CERTIFIED

Third-party tested to certify each home meets the high standards of the Quality 360® program.

*Actual floor plans and elevations may differ from those shown based on modifications, options and improvements to the plans by the builder. The information, text and graphics provided herein are provided by Veridian Homes as a convenience to its customers. Veridian Homes does not warrant the accuracy or completeness of the information, text, graphics and other items contained on this collateral or any other collateral. All prices, promotions and specifications are subject to change at any time without notice based on the discretion of Veridian Homes. © 2025 Veridian Homes, LLC. VH9027 12/25