



The Tribeca | TUCK-UNDER GARAGE

3 Beds | 2½ Baths | 1,644 Sq Ft*



FARMHOUSE



COTTAGE



EGGS SUNNY-SIDE UP IN THE SUNNIEST BREAKFAST NOOK AROUND. Even the coffee tastes better when it's sipped slowly on the sofa anchoring your spacious great room. Head upstairs, slip into the coziest robe from your walk-in closet, then take a quiet moment on the front porch with the morning paper. Because this really is all yours. Welcome to life in The Tribeca.

*Exterior design, square footage and product selections may vary by elevation and neighborhood. Image is an artistic rendering of the home; colors and features may vary.

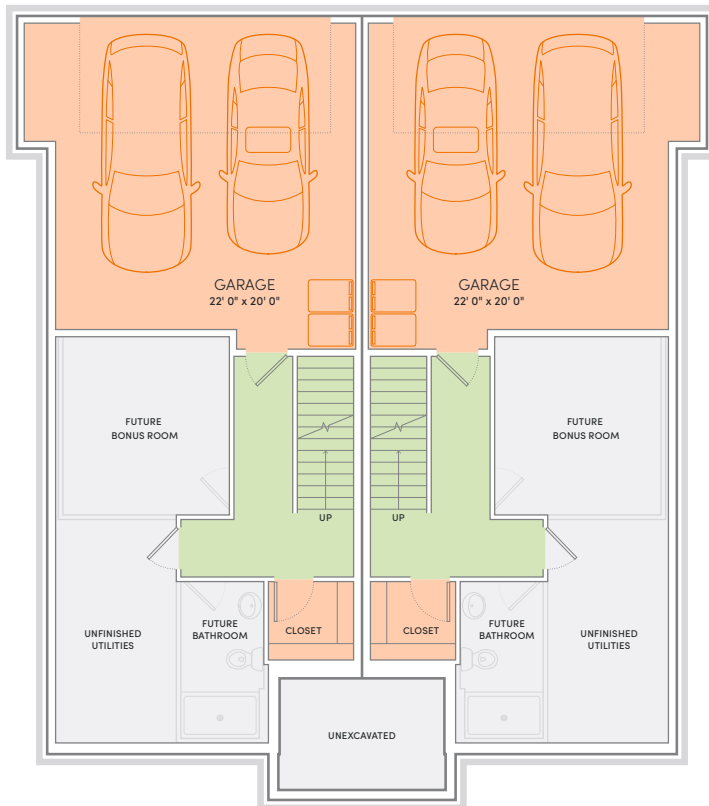
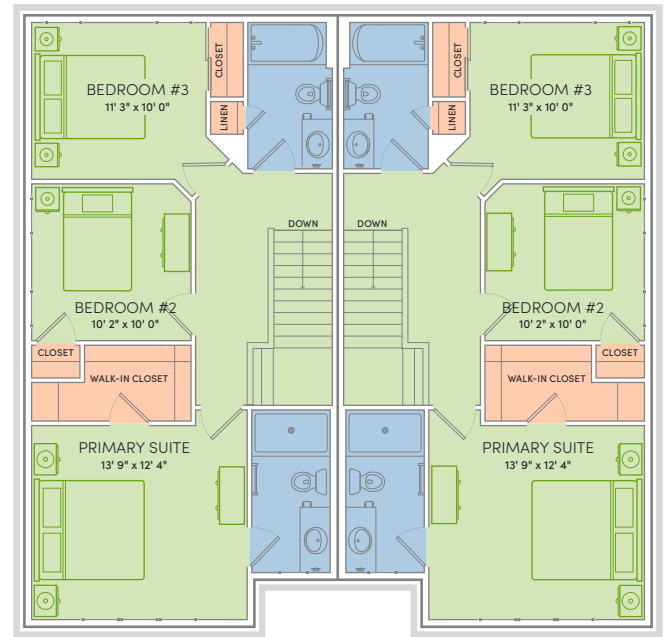
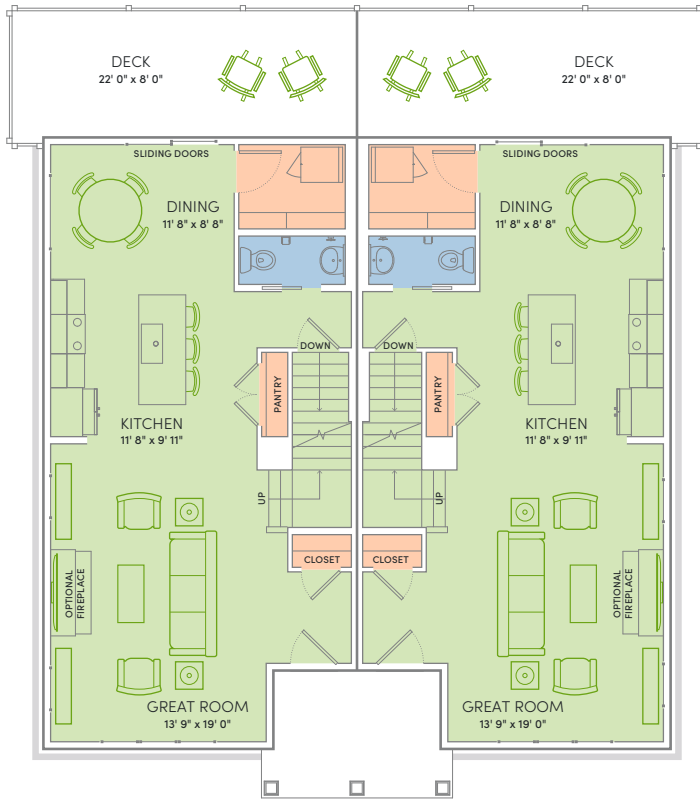

Floor Plan Features



- Locally made, custom Auburn Ridge® cabinetry, doors, and trim crafted to last
- Quality finishes from trusted brands like Kohler®, Moen®, and Shaw®
- Stylish kitchen with island and quartz countertops
- Durable luxury vinyl plank flooring in main living areas
- Designer lighting collections curated from Kichler® and Visual Comfort & Co.
- Painted solid-core doors for superior sound control
- Smart Home+ technology with integrated lighting control and built-in USB connectivity
- One-year warranty for added peace of mind
- Personalize your home in our Design Studio



ENERGY EXPERT CERTIFIED

Third-party tested to certify each home meets the high standards of the Quality 360® program.