



# The Morris

3 Beds | 2½ Baths | 1,678 Sq Ft\*



**THE MORRIS PROVIDES MODERN DAY EASE** with its welcoming foyer and gorgeous great room that spans into the spacious kitchen. Throw in a load of laundry while you master your mother's recipe, then retreat upstairs to your secluded and sophisticated primary suite for the rest and relaxation you deserve. With an open, airy and convenient floor plan, you won't have to go far to feel the comforts of home. Or back to the kitchen for that extra slice of pie.

\*Exterior design, square footage and product selections may vary by elevation and neighborhood. Image is an artistic rendering of the home; colors and features may vary.

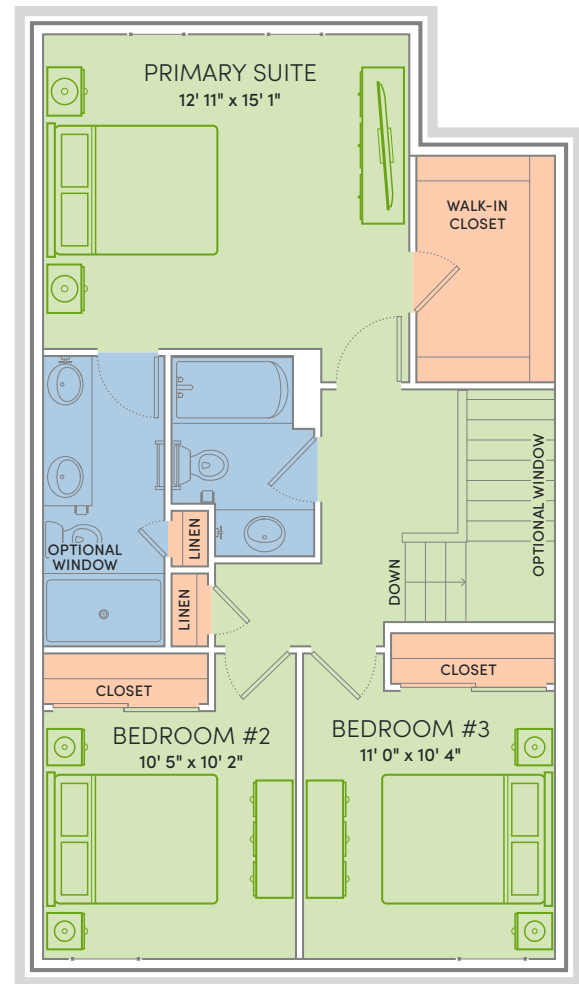
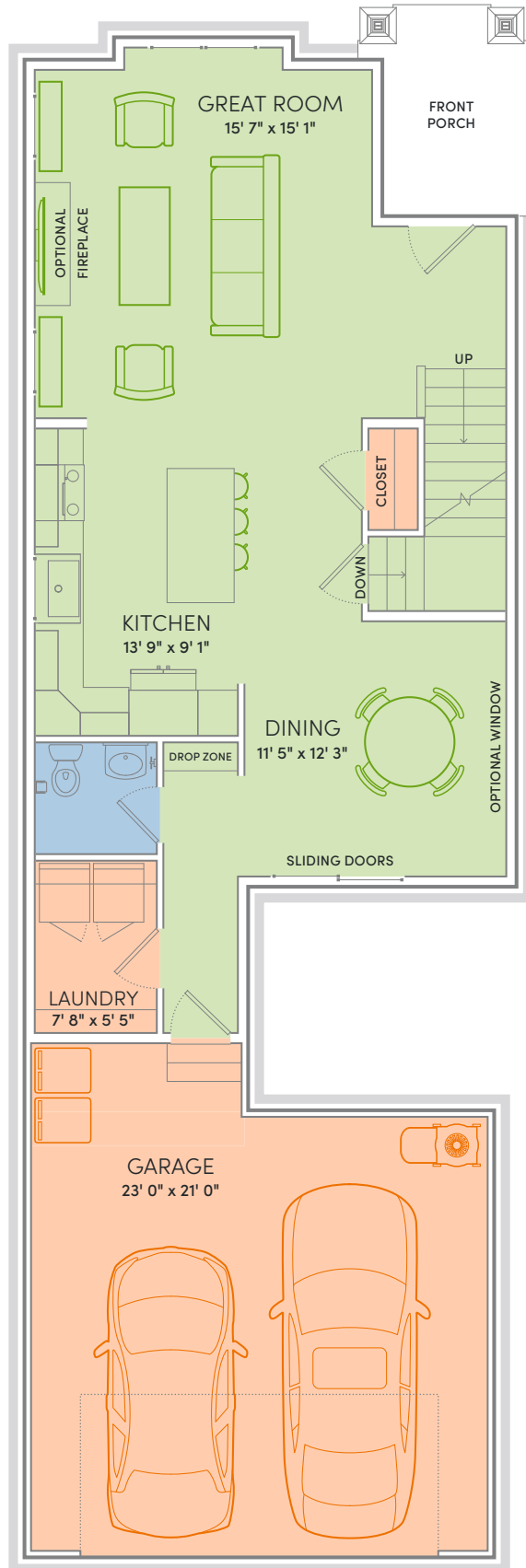

## Floor Plan Features



- Locally made, custom Auburn Ridge<sup>®</sup> cabinetry, doors, and trim crafted to last
- Quality finishes from trusted brands like Kohler<sup>®</sup>, Moen<sup>®</sup>, and Shaw<sup>®</sup>
- Stylish kitchen with island and quartz countertops
- Durable luxury vinyl plank flooring in main living areas
- Designer lighting collections curated from Kichler<sup>®</sup> and Visual Comfort & Co.
- Painted solid-core doors for superior sound control
- Smart Home+ technology with integrated lighting control
- One-year warranty for added peace of mind
- Personalize your home in our Design Studio



### ENERGY EXPERT CERTIFIED

Every Veridian home is tested by a third-party to certify it meets the high standards of the Quality 360<sup>®</sup> program.