



The Harlow

3 Beds | 2 Baths | 1,572 Sq Ft*



CLASSICAL



COTTAGE II



CRAFTSMAN



FARMHOUSE



MODERN



PRAIRIE

ONE LOOK AT THE PRIMARY SUITE IN THE HARLOW AND YOU'LL FEEL YOUR PULSE QUICKEN... an inviting retreat with a private bath and a closet spacious enough to dance in. The kitchen steals the show with a generous island perfect for entertaining, paired with a sunny set of patio doors that welcome in morning light for a quiet cup of coffee before the day begins. This thoughtfully designed single-level home makes everyday living feel effortless.

*Exterior design, square footage and product selections may vary by elevation and neighborhood. Image is an artistic rendering of the home; colors and features may vary.

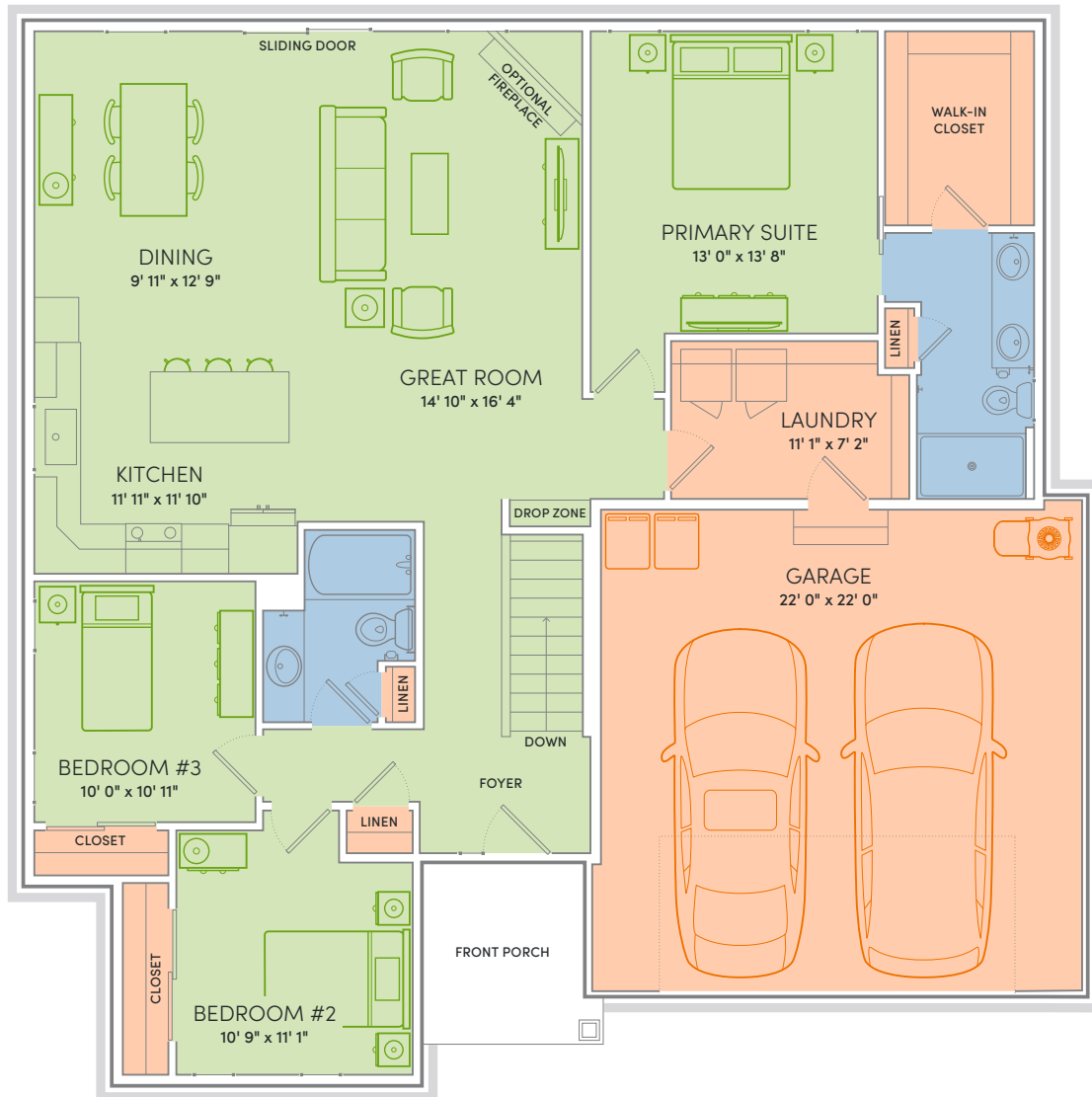

ENERGY EXPERT CERTIFIED
Every Veridian home is tested by a third-party to certify it meets the high standards of the Quality 360® program.

Floor Plan Features



- Locally made, custom Auburn Ridge® cabinetry, doors, and trim crafted to last
- Quality finishes from trusted brands like Kohler®, Moen®, and Shaw®
- Stylish kitchen with island and quartz countertops
- Durable luxury vinyl plank flooring in main living areas
- Designer lighting collections curated from Kichler® and Visual Comfort & Co.
- Painted solid-core doors for superior sound control
- Smart Home+ technology with integrated lighting control and built-in USB connectivity
- One-year warranty for added peace of mind
- Personalize your home in our Design Studio