



# The Aldo | TUCK-UNDER GARAGE

3 Beds | 2½ Baths | 1,612 Sq Ft\*



COTTAGE



MODERN A



MODERN B

\*Exterior design, square footage and product selections may vary by elevation and neighborhood.

**WE MAKE BUILDING EASY.®** When you build a Veridian home, you get much more than a home designed around you and your dreams. You get the peace of mind that comes with nationally-recognized, award-winning, quality craftsmanship and energy efficiency. You get a home that's constructed using innovative building materials as well as the newest technology and building practices. The result is a high-performing, green and energy efficient home that's a healthier home for you and your pocketbook. And when you build with Veridian Homes, you build with a team of specifically trained experts who make homebuilding easy.

THE ALDO UNIT A: FIRST FLOOR

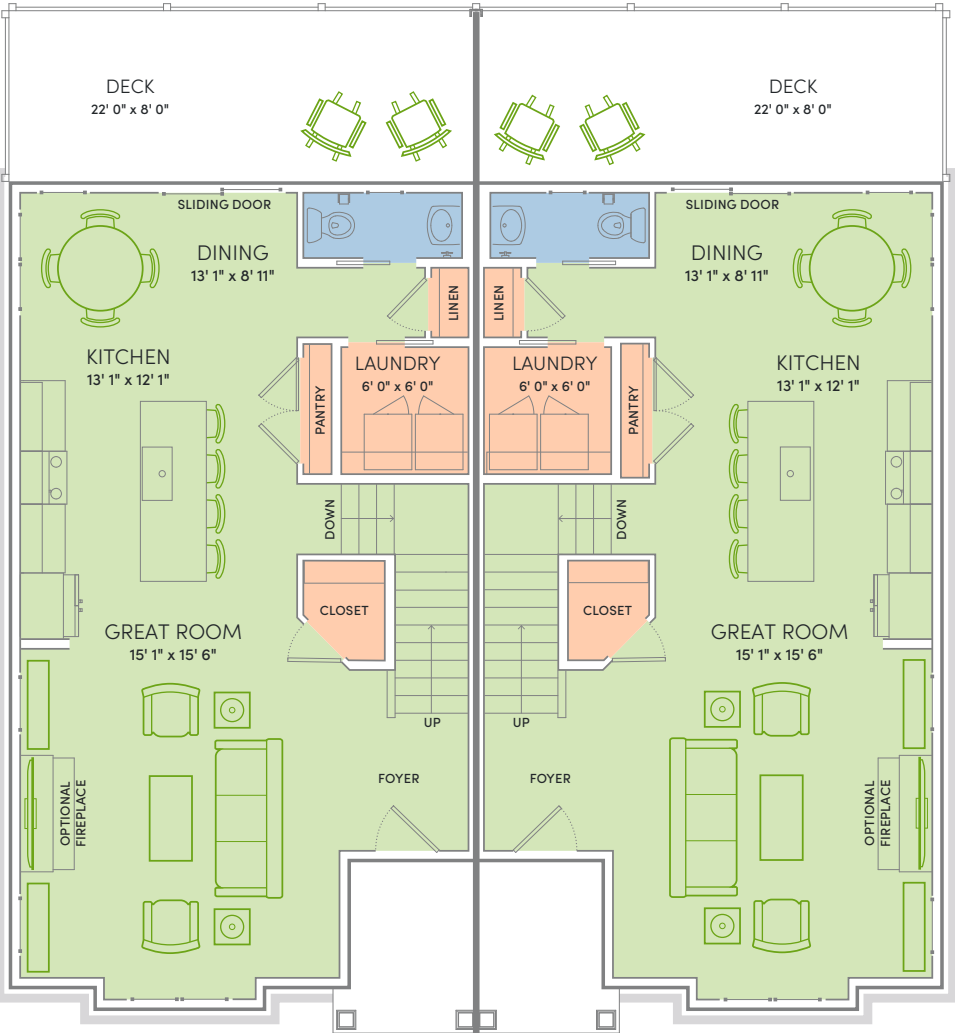

THE ALDO UNIT B: FIRST FLOOR



THE ALDO UNIT A: SECOND FLOOR

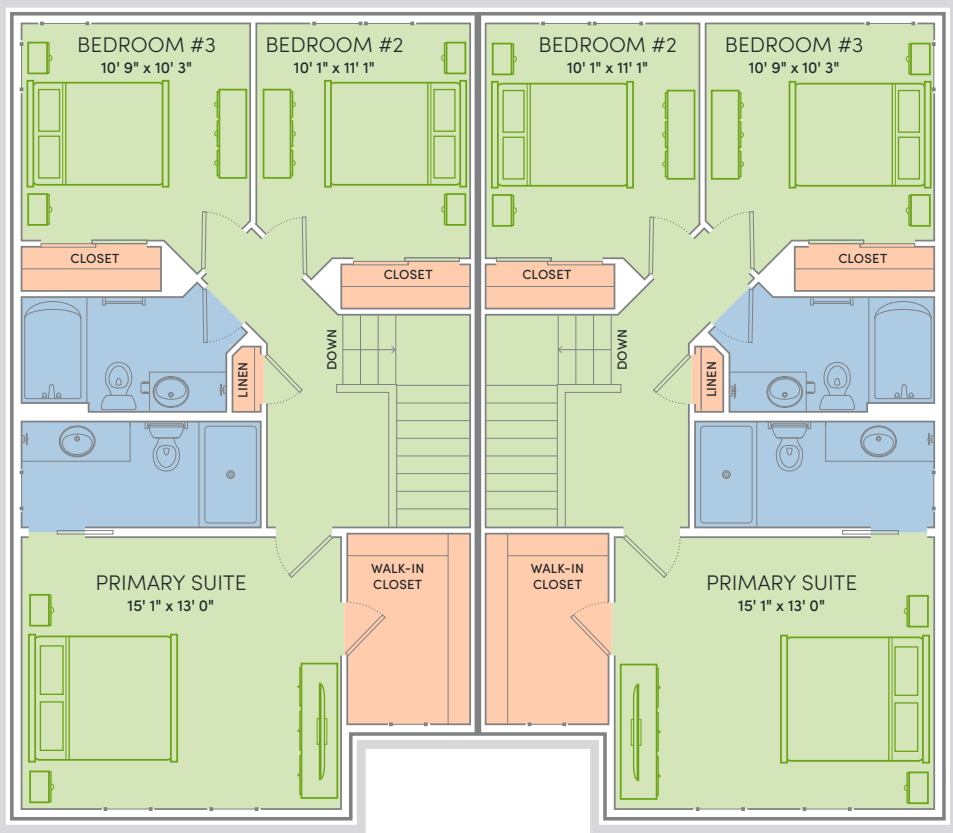

THE ALDO UNIT B: SECOND FLOOR

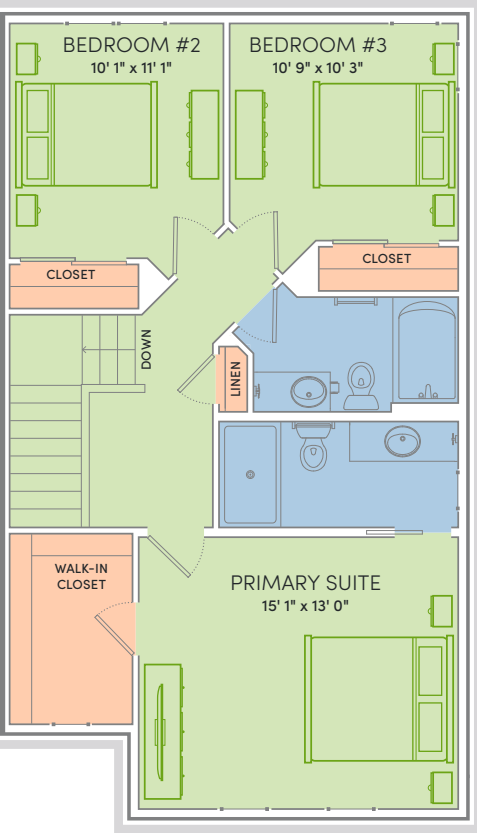

THE ALDO UNIT A: LOWER LEVEL

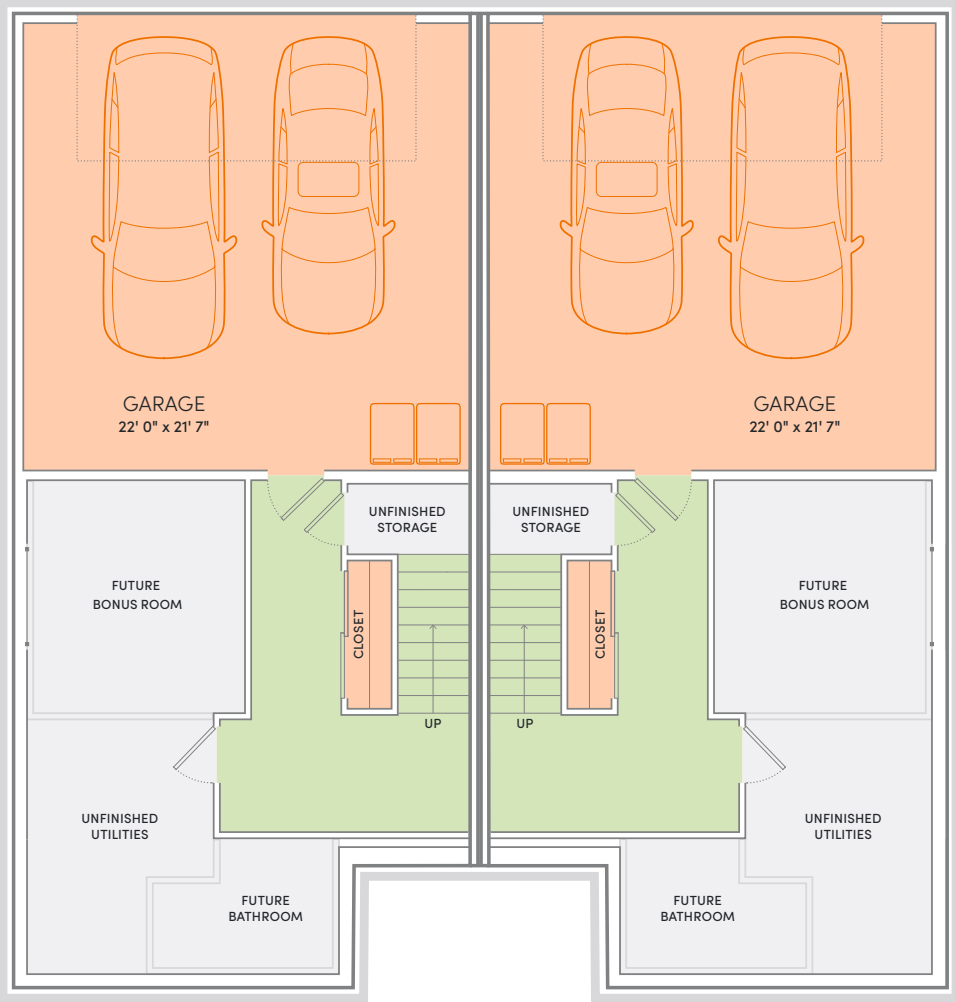

THE ALDO UNIT B: LOWER LEVEL

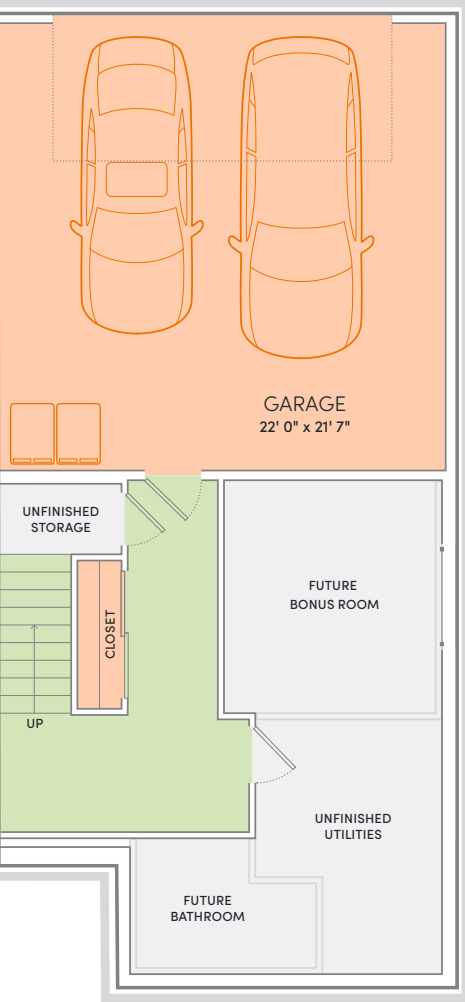

AS YOU WALK IN THE FRONT DOOR, The Aldo Twin Home greets you with a warm welcome home. Gather with friends and family at the large kitchen island. Savor the sun on the back deck. Escape to peace and quiet in the second floor primary suite oasis. With its open and spacious floor plan, The Aldo is designed to accommodate whatever you might have in mind. Welcome home to The Aldo.



\*Features from a similar model

## Floor Plan Features

- Open plan twin home
- Large kitchen island
- Quartz or granite kitchen counters
- Open living, kitchen and dining areas
- Custom Auburn Ridge® cabinetry
- Powder room adjacent to the dining area
- First floor laundry
- Full basement and lower level garage
- Primary suite with private bath and spacious walk-in closet
- Smart Home+ technology
- Energy expert certified
- Award-winning, high-performance home



## A LOOK INSIDE THE ALDO'S ENERGY EFFICIENCY



- Energy Expert Certified
- Insulated Entry Door
- Low-E Insulated Windows
- Insulated Garage Door
- Electronic Programmable Thermostat
- Energy Efficient Led Lighting
- Moen® Low Flow Fixtures
- Energy Star® Bath Fans
- Energy Efficient Air Conditioner, Furnace, and Hybrid Water Heater
- Radon Mitigation System
- 2x6 Framed Walls, 24 on Center
- Tyvek® House Wrap
- Advanced Air Sealing
- Spray Foam Insulation
- Advanced Weather Blocking Adhesive Membrane



### This Home is Quality 360® Certified

Every high-performance, Veridian home is tested by a third-party company, Perfect Environmental Performance (PEP). This testing allows us to individually certify each and every home we build meets the high standards of the Quality 360 program.

The Quality 360 program requires that all homes meet the highest standards in energy-efficiency, combustion safety, comfort and durability. This means that your dream home will not only look like a dream, but it will run like one too.

- Exceeding Expectations
- Better Energy Performance
- Heating/Cooling Loss Protection
- Peace of Mind

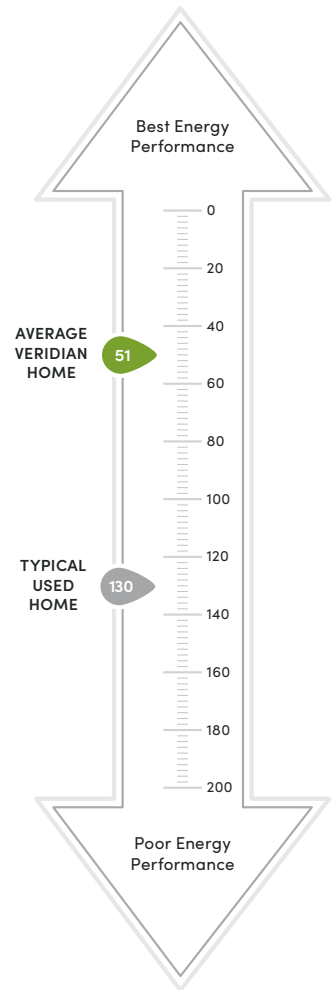

**\$310 in savings every month!\***

LOWER INDEX = HIGHER EFFICIENCY.

A HERS Index is the industry standard by which a home's energy efficiency is measured. A Veridian home receives a rating 56 HERS or better, averaging 51 HERS, compared a typical used home, which rates at 130 HERS – that's greater than a 70% increase in total energy performance. This means that your dream home will not only look like a dream, but it will run like one too.

\*Estimated average monthly energy bill savings with the Aldo. The costs were calculated using REM/Rate™ 12.97 and the HERS Score for the reference homes listed in the arrow chart and were published by RESNET, as compared to the typical used home. The typical used and new home scores were determined by the U.S. Department of Energy.