



The Aldo | TUCK-UNDER GARAGE

3 Beds | 2½ Baths | 1,765 Sq Ft*



FRENCH COUNTRY



COTTAGE



AS YOU WALK IN THE DOOR, THE ALDO TWIN HOME GREETES YOU WITH A WARM WELCOME. Gather with friends and family at the large kitchen island. Savor the sun on the back deck. Escape to peace and quiet in the second floor primary suite oasis. With its open and spacious floor plan, The Aldo is designed to accommodate whatever you might have in mind. Welcome home to The Aldo.

*Exterior design, square footage and product selections may vary by elevation and neighborhood. Image is an artistic rendering of the home; colors and features may vary.

THE ALDO TWIN HOME PLAN

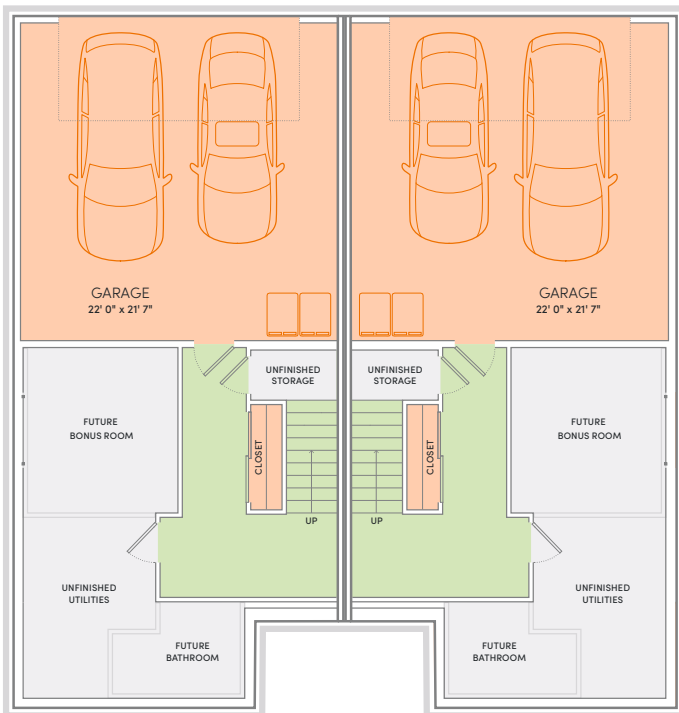
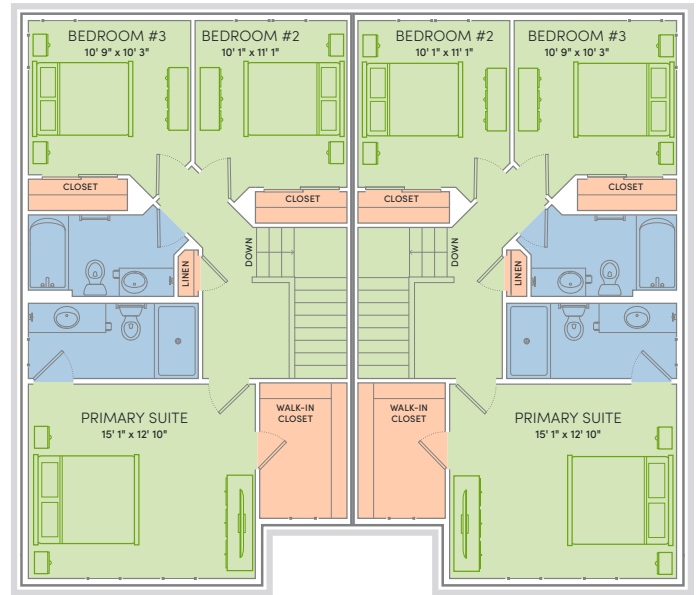

Floor Plan Features



- Locally made, custom Auburn Ridge® cabinetry, doors, and trim crafted to last
- Quality finishes from trusted brands like Kohler®, Moen®, and Shaw®
- Stylish kitchen with island and quartz countertops
- Durable luxury vinyl plank flooring in main living areas
- Designer lighting collections curated from Kichler® and Visual Comfort & Co.
- Painted solid-core doors for superior sound control
- Smart Home+ technology with integrated lighting control and built-in USB connectivity
- One-year warranty for added peace of mind
- Personalize your home in our Design Studio



ENERGY EXPERT CERTIFIED

Third-party tested to certify each home meets the high standards of the Quality 360® program.